



KEY FEATURES

- Conveniently located just off Salem Parkway, near downtown Winston-Salem
- ±12,000 SF with 800 SF office
- 16' clear height
- One 8' x 10' dock door
- \$4.00/SF MG

LEARN MORE ABOUT THIS PROPERTY

JEFF ANDREWS

jeff@commercialrealtync.com
336.793.0890, ext 103

STEVE VALLOS

steve@commercialrealtync.com
336.793.0890, ext 105

INDUSTRIAL WAREHOUSE

\$4.00/SF MG

BROAD STREET WAREHOUSE

300 S. Spring Street, Winston-Salem, NC
27101

Great industrial warehouse space on a quiet street near downtown Winston-Salem! This ±12,000 clean brick building measures ±120' x 100' and offers ±16.5' tall ceilings, concrete flooring with 20' x 20' bays and an ±800 SF office space.

KURT BIRKINS

kurt@commercialrealtync.com
336.793.0890, ext 204

300 S. Spring St.

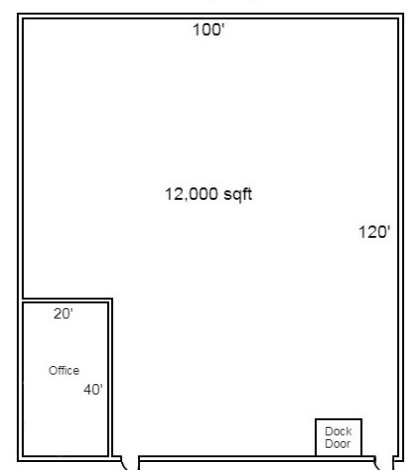



BROAD STREET WAREHOUSE

LOCATION

Address	300 S. Spring Street	City	Winston-Salem	State	NC
Zip Code	27101	County	Forsyth		

PROPERTY DETAILS

Property Type	Industrial	Dimension ±	120' x 100'	Available SF ±	12,000
Ceiling Height ±	16.5'	# Restrooms ±	2	Office SF ±	800
Flooring/Exterior	Concrete/Brick	Docks ±	1	Year Built	1969

TAX INFORMATION

Zoning	GB	Tax Pin	6835-04-5190	Office SF ±	800
---------------	----	----------------	--------------	--------------------	-----

PRICING & TERMS

Lease Rt/SF±	\$4.00	Lease Type	Modified Gross
---------------------	--------	-------------------	----------------

INDUSTRIAL WAREHOUSE

\$4.00/SF MG

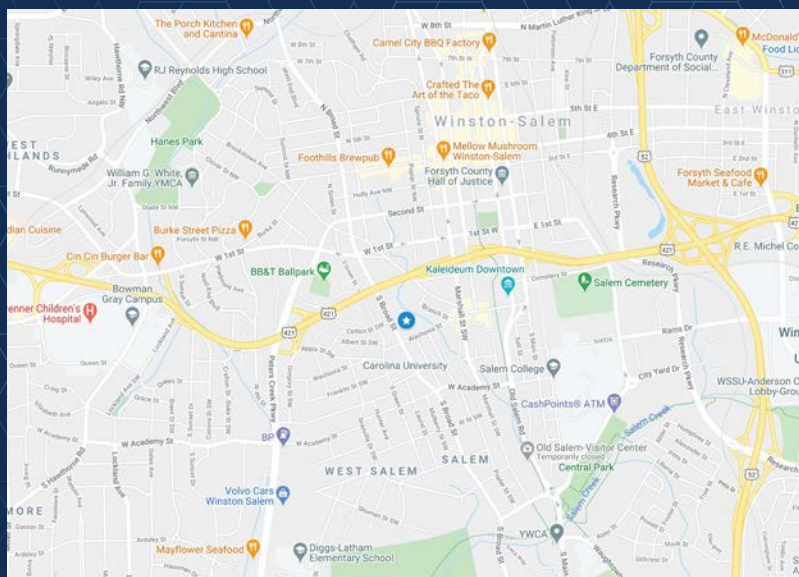

LOCATION FEATURES

- Conveniently located just off Salem Parkway, close to US 52
- Near downtown Winston-Salem and Innovation Quarter